

KH-EZ 5/8"	h_1^*	h_{nom1} = 3.25"	h_{nom2} = 4"	h_{nom3} = 5"	h_{nom4} = 6"
		t_{fix1} max	t_{fix2} max	t_{fix3} max	t_{fix4} max
5/8" x 3 1/2"	3 3/8" - t_{fix}	1/4"	-	-	-
5/8" x 4"	4 3/8" - t_{fix}	3/4"	-	-	-
5/8" x 4 1/2"	4 7/8" - t_{fix}	1 1/4"	1/2"	-	-
5/8" x 5 1/2"	5 7/8" - t_{fix}	2 1/4"	1"	1/2"	-
5/8" x 6 1/2"	6 7/8" - t_{fix}	3 1/4"	2 1/2"	1 1/2"	1/2"
5/8" x 8"	8 3/8" - t_{fix}	4 3/4"	4"	3"	2"

		$h_{nom} < 5"$	$h_{nom} \geq 5"$	
	Nuron SIW 4-22			
	Nuron SIW 6-22			
	Nuron SIW 8-22			
	CPC SIW 22T/18T-A			
	CPC SIW 9-A22/A18			
		85 ft-lb	85 ft-lb	38 ft-lb

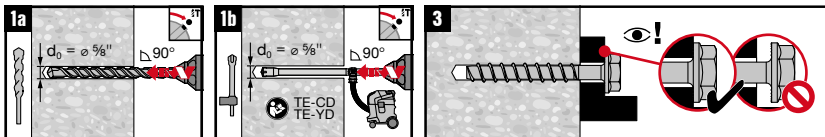

*For non-hole cleaning installation (step 1a), make sure to drill deep enough to achieve h_1 , taking into account the depth of debris remaining in the hole.